

Catalogue & Profile



LABORATORY SPECIALIST

WITH MORE THAN **40**
YEARS OF EXPERIENCE,
WE ARE CONFIDENT
TO PROVIDE YOU THE
BEST SOLUTIONS
THROUGH RESEARCH
AND WIDE ARRAYS OF
PRODUCT SELECTION
TO FIT YOUR NEXT
LABORATORY PROJECTS.

Laboratory Specialist



ROLAND EXPERIENCE

YOUR TRUSTED PARTNER SINCE 1976, CONTINUOUS RESEARCH & DEVELOPMENT TO ENSURE INNOVATIVE PRODUCTS & SERVICES

We have been the premier standard for laboratory design and services in Indonesia since day one through the unprecedented quality of furniture and services that attracts international companies to partner with us in delivering our vision.

We specialise in the manufacture, design, and installation of laboratory furniture. This includes fume hoods, workbenches, balance tables, chemical storage cabinets, glassware cabinets, and other customised laboratory furniture.

We became the first certified laboratory furniture consultant and manufacturer in Indonesia for design, manufacture, installation of laboratory furniture, fume hood, and its accessories and gained Quality System Certification ISO 9001.

Your trust and satisfaction as our customers are our measures of success. We are committed to delivering excellence in everything we do. The constantly changing demand in the market inspires us to create a flexible, durable, ergonomic, and aesthetically-pleasing design of modern laboratory.

VISION

To be the leading and trusted provider of laboratory fixtures and furniture driven by our passion and commitment to service and product quality.

MISSION

We strive to be the top of mind brand of laboratory furniture provider in Indonesia by maintaining the highest quality in our innovative products and services at all times through continuous growth.



OUR SPECIALITY

Lab Furniture

At Roland, we have a wide range of selections of state-of-the-art furniture and fixtures to fulfill the need to build a laboratory facility for commercial needs or educational purposes and offer the best warranty in the industry. You can count on us to provide the highest craftsmanship of components from general laboratory furniture, fume hoods, laboratory accessories, laboratory safety product, specialized items, or gas, pipe & duct that we are proudly produced in our own warehouse with the assistance

of our expert technicians that will inspect and ensure that all of the products have gone through the process of Quality Management System ISO 9001.

Lab Consultant

Our deep understanding of the industry provided us with know-how knowledge on how to fulfill your ideal laboratory using the innovative modular furniture technology. Research that we conduct continuously ensures that we can stay ahead of our competitors and provide you with insights and recommendations.

WHY ROLAND

Quality Assurance

Years of experience in the industry taught us that bringing the best people with a passion for building the finest laboratory furniture is the key to providing the highest quality products and it should stay that way. Let us ensure that you can maximize the use of your laboratory with no hassle.

Proven Efficiency

We are your partner in crafting the best laboratory furniture and fixtures. Let us work with you to provide the most efficient

solution to ensure that you can get your laboratory up and running as soon as possible. It should be the beginning of a great partnership, so you can focus on what matters for the business.

Safety Standards

Using our products should give ease of mind without compromising safety. Our technicians are hands-on and take account of each detail to ensure that all installations will follow the safety standard. wwt

There is no
substitute
to quality



HISTORY & ACHIEVEMENTS



Proven by time

197619811982-19901991-20002001-20102011- Present

We were established in **1976** and produced high-quality general office and household furniture item.

We became PT Roland Golden Age specializing in laboratory furniture and became the first to provide laboratory furniture design consultancy and manufacturer in Indonesia.

We introduced a logo with a fresh brand image and established our first factory in Ciputat. We became the first to introduce Phenolic Resin / Epoxy Resign Worktop and other quality lab accessories in Indonesia. We also became the pioneer in producing first-ever locally-made Fume Hood and created its trademark R series furniture.

We introduced new product designs and began exporting to the Republic of the Marshall Islands and became affiliated with several International Furniture companies and laboratory utilities suppliers which strengthened our position in the market. We exhibited in many local and international expos and conforming our products to American and European laboratory design standards.

We upgraded some major pieces of machinery to achieve higher precision and established our second factory in Techno Park, Bumi Serpong Damai (BSD), Banten. At the same year, The Ministry of Trade of the Republic of Indonesia awarded us with Potential Exporter for Medium-Sized business, achieved global quality system certification & ISO 9000:2001 by BQSS and KAN, re-certified by TUV NORD Indonesia on ISO 9001:2008, and showcasing our best products at Lab Asia 2010; the first international exhibition focusing on laboratory, analytical, and equipment

We collaborated with Erlab group France to promote Ductless Filtration System and Green Fume Hood and joined the Lab Asia in 2012 and 2014 as part of our effort to showcase our best products like new high-quality metal-based furniture.

SERVICES

Design & Engineering

Our objective is to ensure that our laboratory furniture and accessories meet your standards.

CAD Services

Precision is in our DNA, therefore we will provide CAD drawings to enable you to visualize and evaluate the plan

Laboratory Site Installation

You can rely on us to ensure that that the installation will follow the National and International Standards.

Project Analysis

Thinking of starting a project? Contact us and our team will visit your location, conduct the survey of the location, and provide a comprehensive report to assist you in your planning.

SOLUTION FOR TODAY'S LABORATORY

Laboratory Furniture Consultation

'Be confident with our professional opinion on laboratory functionality, room size, space accessibility, type of materials to use, utility management, number of users, safety & hygiene issues, airflow, gas line system, drainage system, workstation customisation that would meet both your requirements and budget

Laboratory Relocation & Upgrade

Call our professional team should you need to upgrade, dismantle, remove, and install laboratory furniture products at your desire

After Sales Services & Warranty

Your satisfaction is everything, therefore, we will ensure that you will receive the best after-sales services even after the warranty expires.

Fume Hood Test & Inspection

Count of us when you need to test and check fume hoods as we based our inspection on ANSI-ASHRAE 100-1995 standards

PRODUCT LINES

BRINGING THE BEST
EXPERIENCE TO YOUR
LABORATORY, WITH OUR
PRODUCT LINES

01 THE FURNITURE:

TYPE R

- 1. Wall Bench Type R
 - a. Wall Bench I Type UK 1000 & 1200
 - b. Wall Bench I Type UK 1500 & 1800
 - c. Wall Bench I Type With Sink
- 2. Island Bench Type R
 - a. Island Bench With Sink
 - b. Island Bench With Center Rack
- 3. Hanging Rack
- 4. Glassware Cabinet

TYPE B

- 1. Steel Structure
- 2. Steel Box Cabinet
- 3. Balance Table
- 4. Steel Storage
- 5. Chemical Storage
 - a. Flammable Cabinet
 - b. Corrosive Cabinet

02 FUME HOOD

- 1. Fume Hood RL
- 2. Ductless Fume Hood
- 3. Double Side Fume Hood

03 ACCESSORIES

- 1. Pegboard
- 2. Local Extractor
- 3. Emergency Shower
- 4. Water Fitting
- 5. Gas Fitting
- 6. Sink
- 7. Counter Top

04 SPECIAL ITEMS

- 1. Sensory Bench
- 2. SS Hood
- 3. Low Bench with shoe rack (Phenolic) & (Stainless Steel)
- 4. Passbox
- 5. Incubator Rack

05 GASLINE

MATERIALS

TRANSFORMING YOUR
VISION INTO A REALITY

Our modular components will enable you to customizes between wood or steel. Both have different properties and functions.

The wood base technology is commonly used in Indonesia but you can choose from our wide varieties of steel materials to suit your needs. Currently, we offer three types of laboratory furniture. First, Type R is based on a solid wood structure to give a sophisticated look at the furniture. Secondly, Type RL is made entirely made of steel that insinuates the items inside the space. Thirdly, you can also choose the Type RL+ through a combination of steel structure with a wooden cabinet box to captivate every eye on the room. The innovation from our research and development team will bring the best idea to fulfill the demand for functional yet beautiful laboratory furniture.

Wood

Our Type R Roland Wood Furniture is our gold standard for 30 years in Indonesia. Made of solid wood covered with eproxy paint that is resistant to chemicals and could hold heavy loads. The silicone seal will help to prevent dirt and dust accumulation and you can adjust the furniture according to the room size.

Module system with solid ovenbaked wood structure & epoxy paint coated, thickness 2.5 cm

Clipping metal hinges ex FGV (Italy)

Heavy duty metal slidding rails ex FGV (Italy)

High quality PP handle, chemical resistance embedded

Drawer & Door panel, plywood laminated with HPL sheet postformed ex import (No sharp edges)

Max load 150 kg / m' for benches

Steel

Type RL is made entirely of steel. The modular knock-down system is highly flexible, corrosive-resistant, and capable to hold heavy loads over 200 kg/m2. Not only that, it is budget-friendly and recommended for a fast-growing laboratory. Equipped with a metal box cabinet (C-Frame), you can easily replace and move as you place.

Flexible & adaptable C frame steel structure 2.6 mm (SPHC) with black stoving varnish

Clipping metal hinges 105°,with no slamming noise

1.2 mm galvanized steel rail with 3 segments, easily to detachable

High quality PP drawer, with label holder

Drawer & doors, one piece construction (no welding), 10% SPCC with black stoving varnish

Max load 250 kg/m' for benches

THE FURNITURE 01

Type R Wall Bench Type UK 1000 & 1200

The Furniture

The Furniture



On Picture
1-2.Wall Bench I Type

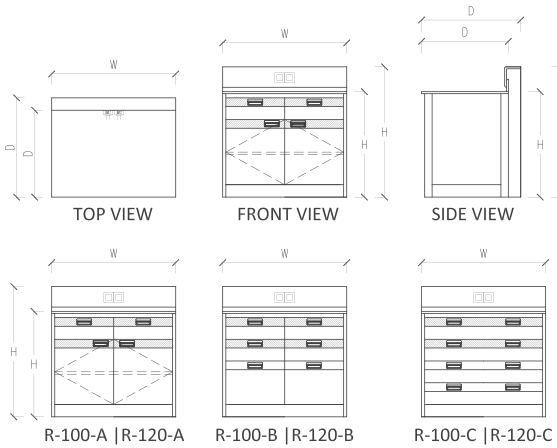
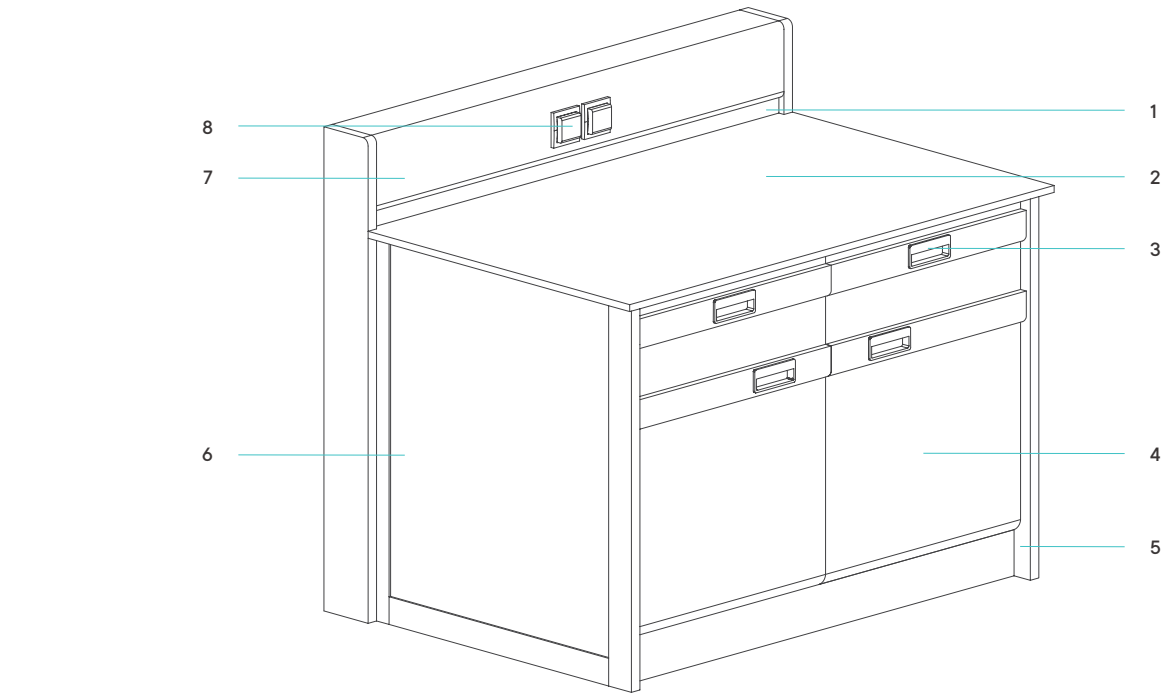

No	Spesification	Material
1	Back Splash	Phenolic Resin/Epoxy Resin/Ply-wood with HPL post-formed
2	Toptable/Worktop	Phenolic Resin/Epoxy Resin/Ply-wood with HPL post-formed
3	Handle	High Quality PP
4	Door Panel	Plywood with HPL post-formed
5	Structure	Solid Wood (Oven Dried & Epoxy Coated)
6	Side Cover	Plywood with HPL Seet
7	Utility Channel	Plywood with HPL Post-formed
8	Electrical Socket	IP44/IP55 (Optional)

Modul	Type	Dimension (mm)			Modul	Type	Dimension (mm)		
		W	D	H			W	D	H
R-100-A	R-100-A1	1000	700/800	850/1050	R-120-A	R-120-A1	1200	700/800	850/1050
	R-100-A2	1000	750/850	850/1050		R-120-A2	1200	750/850	850/1050
	R-100-A3	1000	800/900	850/1050		R-120-A3	1200	800/900	850/1050
R-100-B	R-100-B1	1000	700/800	850/1050	R-120-B	R-120-B1	1200	700/800	850/1050
	R-100-B2	1000	750/850	850/1050		R-120-B2	1200	750/850	850/1050
	R-100-B3	1000	800/900	850/1050		R-120-B3	1200	800/900	850/1050
R-100-C	R-100-C1	1000	700/800	850/1050	R-120-C	R-120-C1	1200	700/800	850/1050
	R-100-C2	1000	750/850	850/1050		R-120-C2	1200	750/850	850/1050
	R-100-C3	1000	800/900	850/1050		R-120-C3	1200	800/900	850/1050

Type R Wall Bench Type UK 1500 & 1800

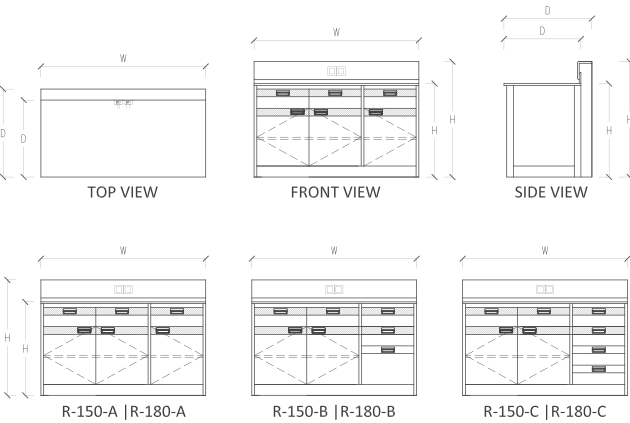
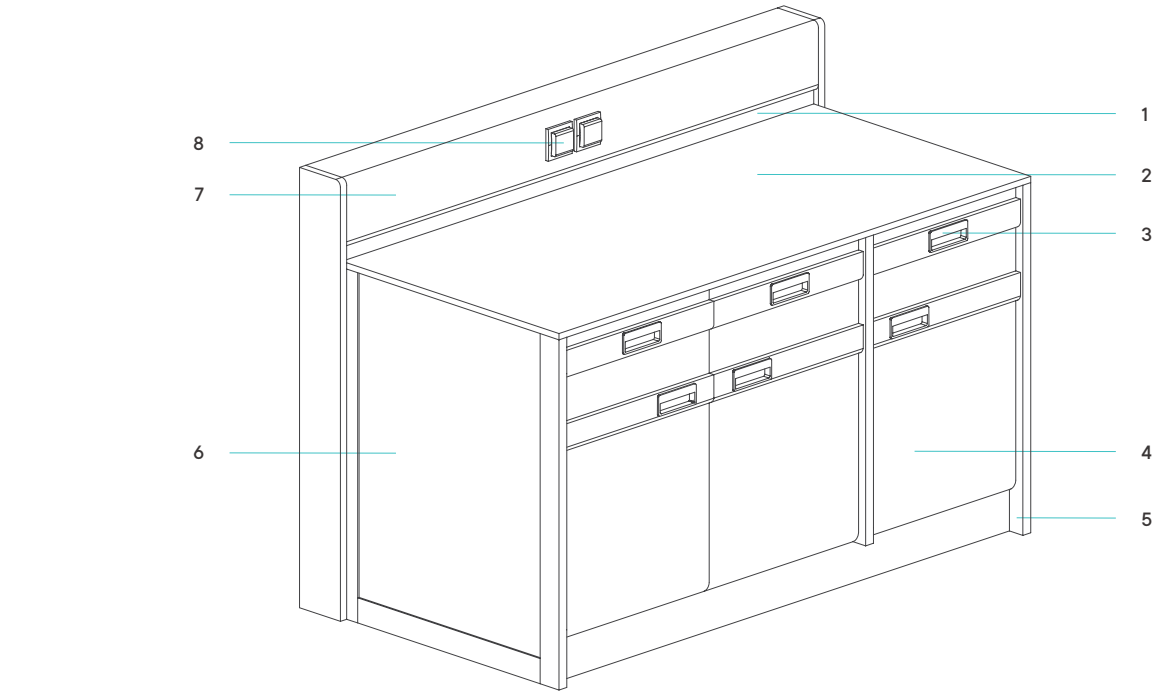

No	Spesification	Material
1	Back Splash	Phenolic Resin/Epoxy Resin/Ply-wood with HPL post-formed
2	Toptable/Worktop	Phenolic Resin/Epoxy Resin/Ply-wood with HPL post-formed
3	Handle	High Quality PP
4	Door Panel	Plywood with HPL post-formed
5	Structure	Solid Wood (Oven Dried & Epoxy Coated)
6	Side Cover	Plywood with HPL Seet
7	Utility Channel	Plywood with HPL Post-formed
8	Electrical Socket	IP44/IP55 (Optional)

Modul	Type	Dimension (mm)			Modul	Type	Dimension (mm)		
		W	D	H			W	D	H
R-150-A	R-150-A1	1500	700/800	850/1050	R-180-A	R-180-A1	1800	700/800	850/1050
	R-150-A2	1500	750/850	850/1050		R-180-A2	1800	750/850	850/1050
	R-150-A3	1500	800/900	850/1050		R-180-A3	1800	800/900	850/1050
R-150-B	R-150-B1	1500	700/800	850/1050	R-180-B	R-180-B1	1800	700/800	850/1050
	R-150-B2	1500	750/850	850/1050		R-180-B2	1800	750/850	850/1050
	R-150-B3	1500	800/900	850/1050		R-180-B3	1800	800/900	850/1050
R-150-C	R-150-C1	1500	700/800	850/1050	R-180-C	R-180-C1	1800	700/800	850/1050
	R-150-C2	1500	750/850	850/1050		R-180-C2	1800	750/850	850/1050
	R-150-C3	1500	800/900	850/1050		R-180-C3	1800	800/900	850/1050

Type R Wall Bench With Sink

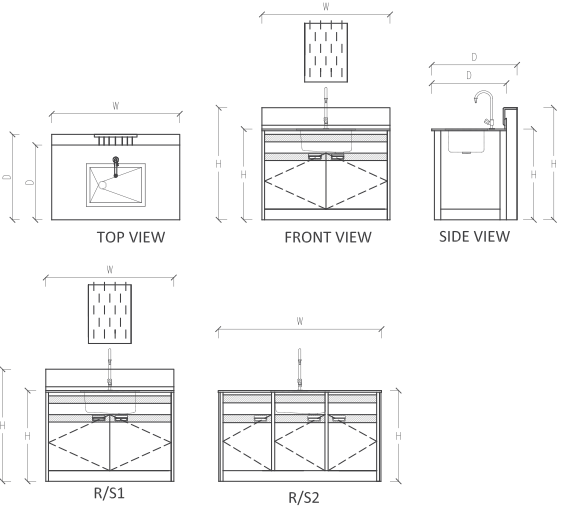
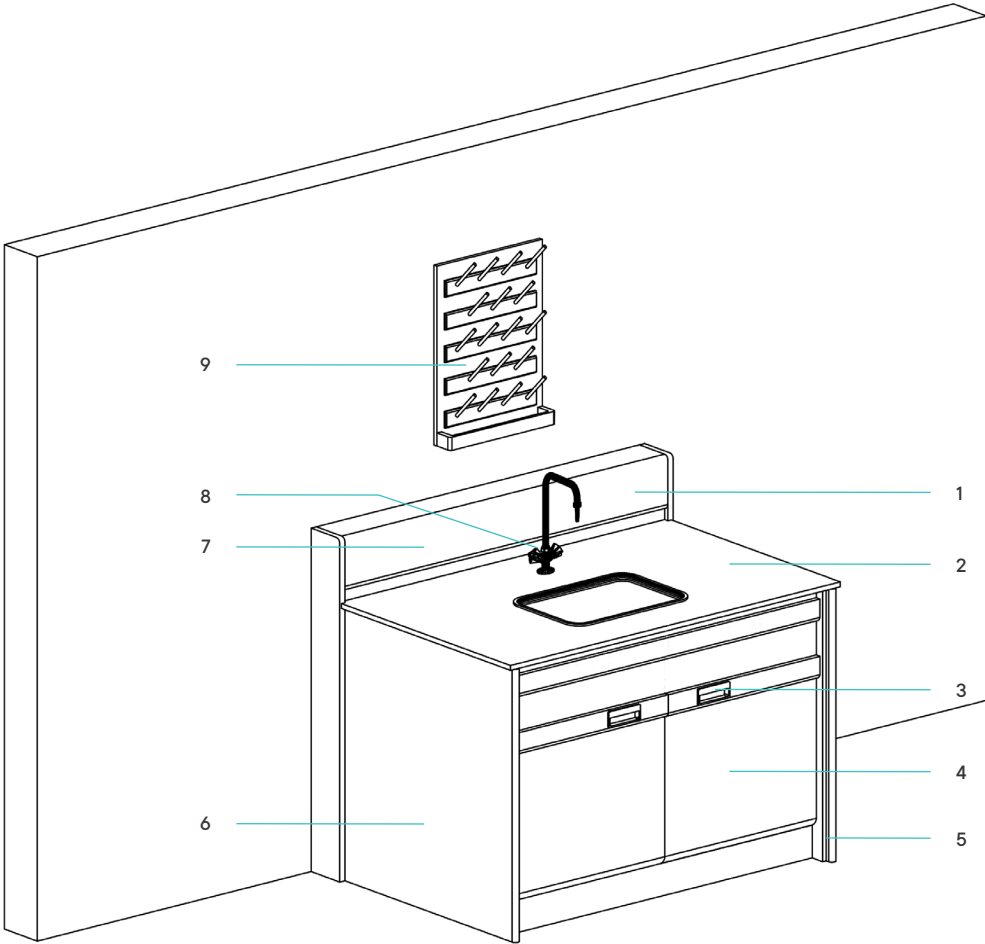

Modul	Type	Dimension (mm)			Modul	Type	Dimension (mm)		
		W	D	H			W	D	H
R-150-A	R-150-A1	1500	700/800	850/1050	R-180-A	R-180-A1	1800	700/800	850/1050
	R-150-A2	1500	750/850	850/1050		R-180-A2	1800	750/850	850/1050
	R-150-A3	1500	800/900	850/1050		R-180-A3	1800	800/900	850/1050
R-150-B	R-150-B1	1500	700/800	850/1050	R-180-B	R-180-B1	1800	700/800	850/1050
	R-150-B2	1500	750/850	850/1050		R-180-B2	1800	750/850	850/1050
	R-150-B3	1500	800/900	850/1050		R-180-B3	1800	800/900	850/1050
R-150-C	R-150-C1	1500	700/800	850/1050	R-180-C	R-180-C1	1800	700/800	850/1050
	R-150-C2	1500	750/850	850/1050		R-180-C2	1800	750/850	850/1050
	R-150-C3	1500	800/900	850/1050		R-180-C3	1800	800/900	850/1050

No	Spesification	Material
1	Sink	Chemical Resistant PP
2	Toptable/Worktop	Phenolic Resin/Epoxy Resin/Plywood with HPL post-formed
3	Handle	High Quality PP
4	Door Panel	Plywood with HPL post-formed
5	Structure	Solid Wood (Oven Dried & Epoxy Coated)
6	Side Cover	Plywood with HPL Seet
7	Utility Channel	Plywood with HPL Post-formed
8	Water Outlet	Chemical Resistant Fitting
9	Pegboard	Phenolic Resin

Type R Island Bench With Sink

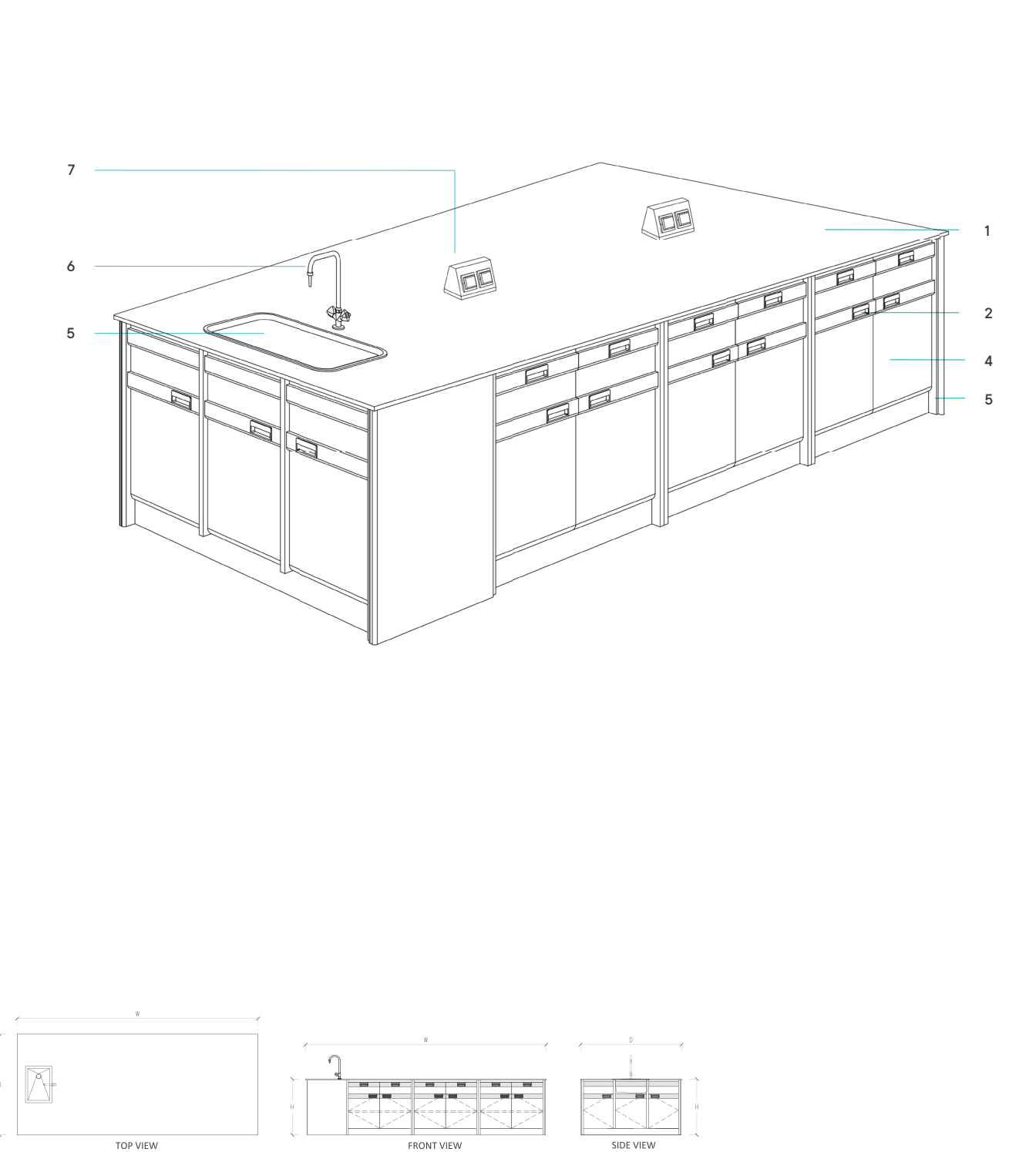

Modul	Dimension (mm)			No	Spesification	Material
	W	D	H			
IB/S/R-240	2450	1530	850	1	Toptable/Worktop	Phenolic Resin/Epoxy Resin/ Plywood with HPL post-formed
IB/S/R-300	3050	1530	850	2	Handle	High Quality PP
				3	Door Panel	Plywood with HPL post-formed
IB/S/R-360	3650	1530	850	4	Side Cover	Plywood with HPL post-formed
				5	Sink	Chemical Resistant PP
IB/S/R-420	4250	1530	850	6	Water Outlet	Chemical Resistant Fitting
				7	Electrical Socket	IP44/IP55 (Optional)
IB/S/R-480	4850	1530	850			

Type R Island Bench With Center Rack

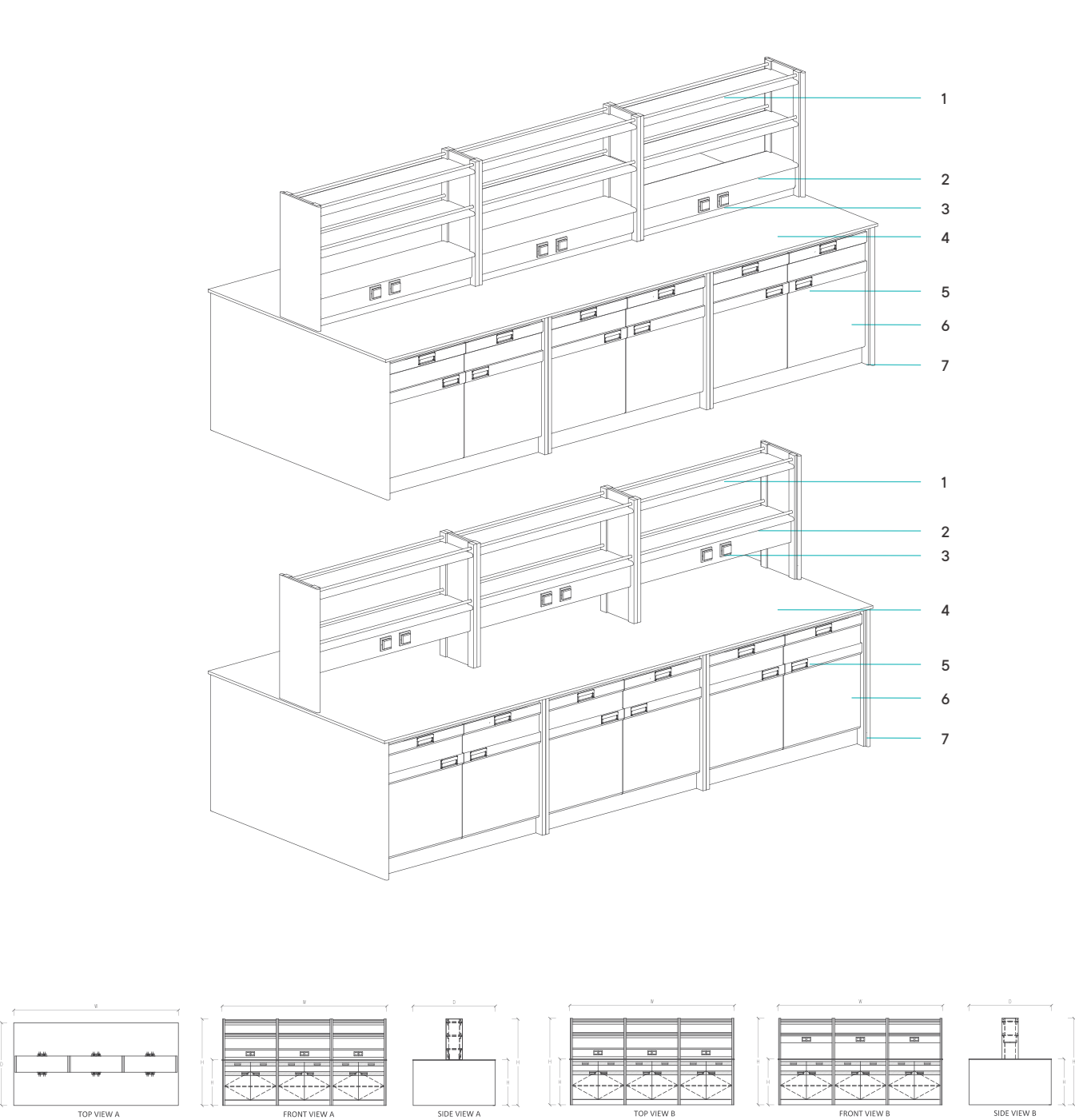

Modul	Type	Dimension (mm)			No	Spesification	Material
		W	D	H			
IB/CR/R-240	IB/CR/R-240-A	2450	1530	850	1	S/S Bar	Stainless Steel
	IB/CR/R-240-B	2450	1200	850	2	Shelves	Plywood with HPL post-formed/Glass 10mm
IB/CR/R-300	IB/CR/R-300-A	3050	1530	850	3	Electrical Socket	IP44/IP55 (Optional)
	IB/CR/R-300-B	3050	1200	850	4	Toptable/Worktop	Phenolic Resin/Epoxy Resin/ Plywood with HPL post-formed
IB/CR/R-360	IB/CR/R-360-A	3650	1530	850	5	Handle	High Quality PP
	IB/CR/R-360-B	3650	1200	850	6	Door Panel	Plywood with HPL post-formed
IB/CR/R-420	IB/CR/R-420-A	4250	1530	850	7	Side Cover	Plywood with HPL post-formed
	IB/CR/R-420-B	4250	1200	850			
IB/CR/R-480	IB/CR/R-480-A	4850	1530	850			
	IB/CR/R-480-B	4850	1200	850			

Type R Glassware Cabinet

Glassware Cabinet

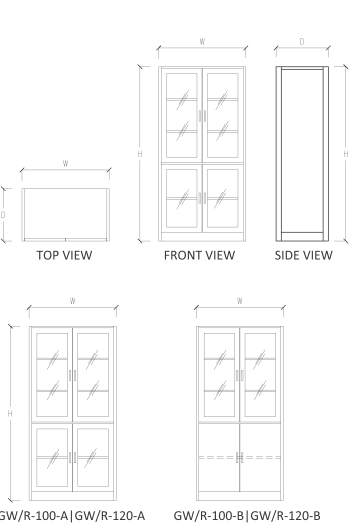

Modul	Type	Dimension (mm)		
		W	D	H
GW/R-100-A	GW/R-100-A1	1000	600	2000
	GW/R-100-A2	1000	500	2000
GW/R-100-B	GW/R-100-B1	1000	600	2000
	GW/R-100-B2	1000	500	2000
GW/R-120-A	GW/R-120-A1	1000	600	2000
	GW/R-120-A2	1000	500	2000
GW/R-120-B	GW/R-120-B1	1000	600	2000
	GW/R-120-B2	1000	500	2000

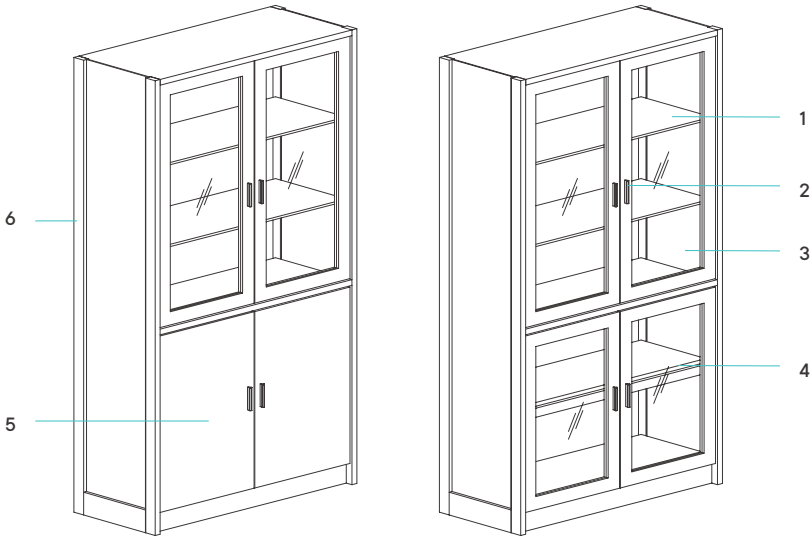

No	Spesification	Material
1	Shelves	Glass 10mm
2	Handle	Stainless Steel
3	Door Panel	Wooden Frame Glass Door
4	Shelves	Plywood with HPL Post-formead
5	Door Panel	Plywood with HPL Post-formead
6	Structure	Solid Wood (Oven Dried & Epoxy Coated)

Type R Hanging Rack

Hanging Rack

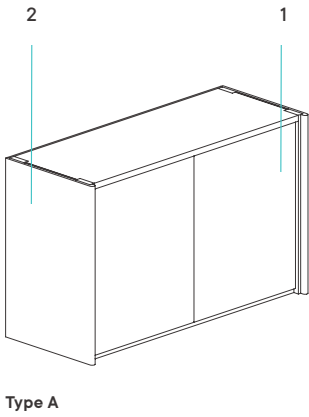
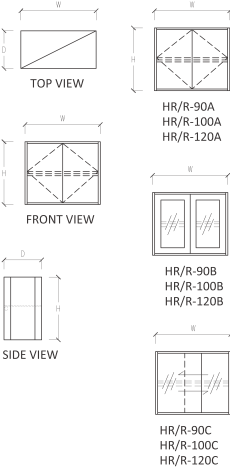

Type A

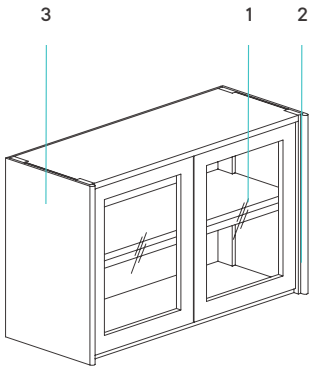

Type B

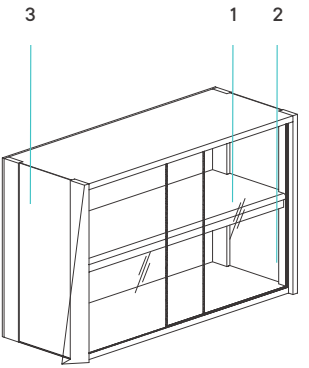

Type C

Modul	Type	Dimension (mm)		
		W	D	H
HR/R-90	HR/R-90-A	900	450	750
	HR/R-90-B	900	450	750
	HR/R-90-C	900	450	750
HR/R-100	HR/R-100-A	1000	450	750
	HR/R-100-B	1000	450	750
	HR/R-100-C	1000	450	750
HR/R-120	HR/R-120-A	1200	450	750
	HR/R-120-B	1200	450	750
	HR/R-120-C	1200	450	750

No	Spesification	Material
Type A		
1	Door Panel	Plywood with HPL post-formed
2	Structure	Solid Wood (Oven Dried & Epoxy Coated)
Type B		
1	Shelves	Plywood with HPL post-formed
2	Door Panel	Wooden Frame Glass Door
3	Structure	Solid Wood (Oven Dried & Epoxy Coated)
Type C		
1	Shelves	Plywood with HPL post-formed
2	Door Panel	Frame Glass Door
3	Structure	Solid Wood (Oven Dried & Epoxy Coated)

Type B Steel Structure & Steel Box Cabinet

The Furniture



On Picture
Wall Bench I Type (Type B)

The Furniture

Steel Structure

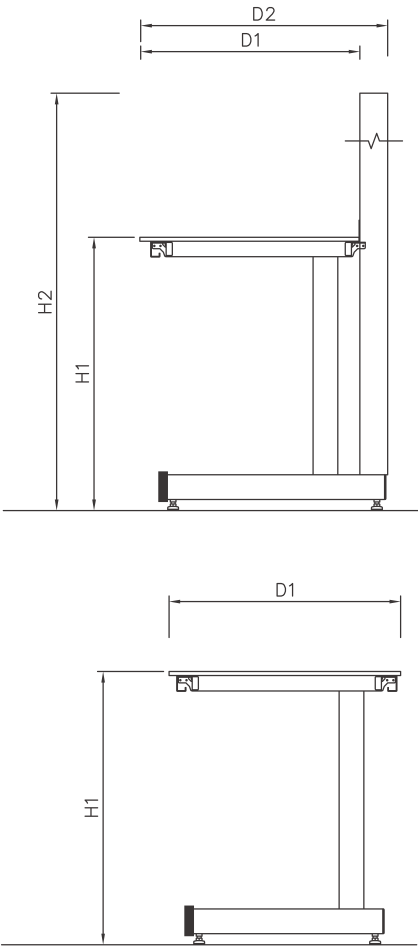

Steel Box Cabinet

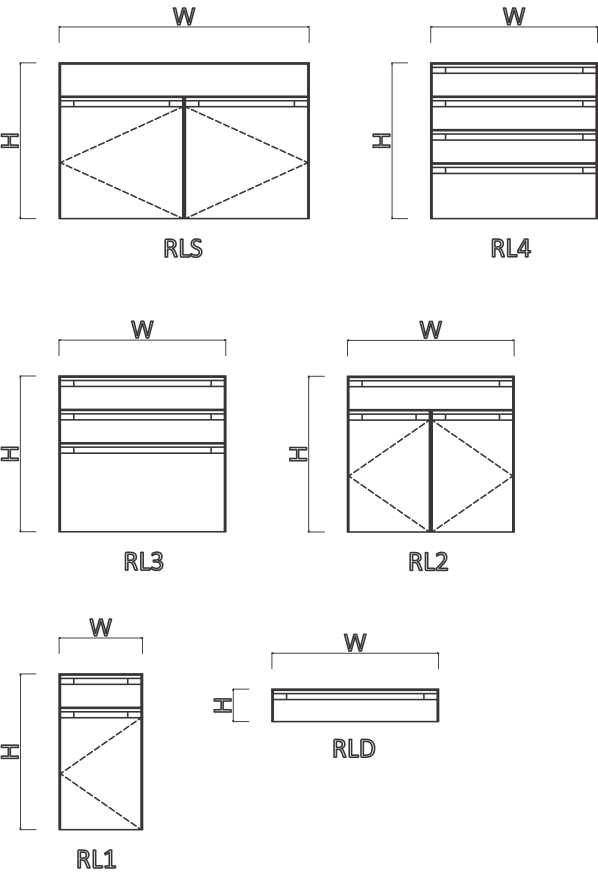

Steel Structure Details

Table Height	H1	H2	D1	D2
90H	855 ~ 910	2295 ~ 2220/ 2395 ~ 2420	600	750
			710	800
			755	845
			800	890
			860	950
82.5H	810 ~ 835	2295 ~ 2220/ 2395 ~ 2420	600	750
			710	800
			755	845
			800	890
			860	950
75H	810 ~ 835	2295 ~ 2220/ 2395 ~ 2420	600	750
			710	800
			755	845
			800	890
			860	950

Table Height	H1	D1
90H	855 ~ 910	710
		755
		800
		860
		900
82.5H	810 ~ 835	710
		755
		800
		860
		900
75H	810 ~ 835	710
		755
		800
		860
		900

Steel Box Cabinet Details

Type	Dimension (mm)		
	W	D	H
RL1	1125	520	700
RL2	375	520	700
RL3	750	520	700
RL4	750	520	700
RLS	1125	520	700
RLD	750	520	700

Type B Balance Table

The Furniture

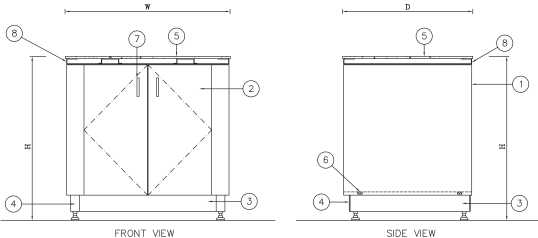
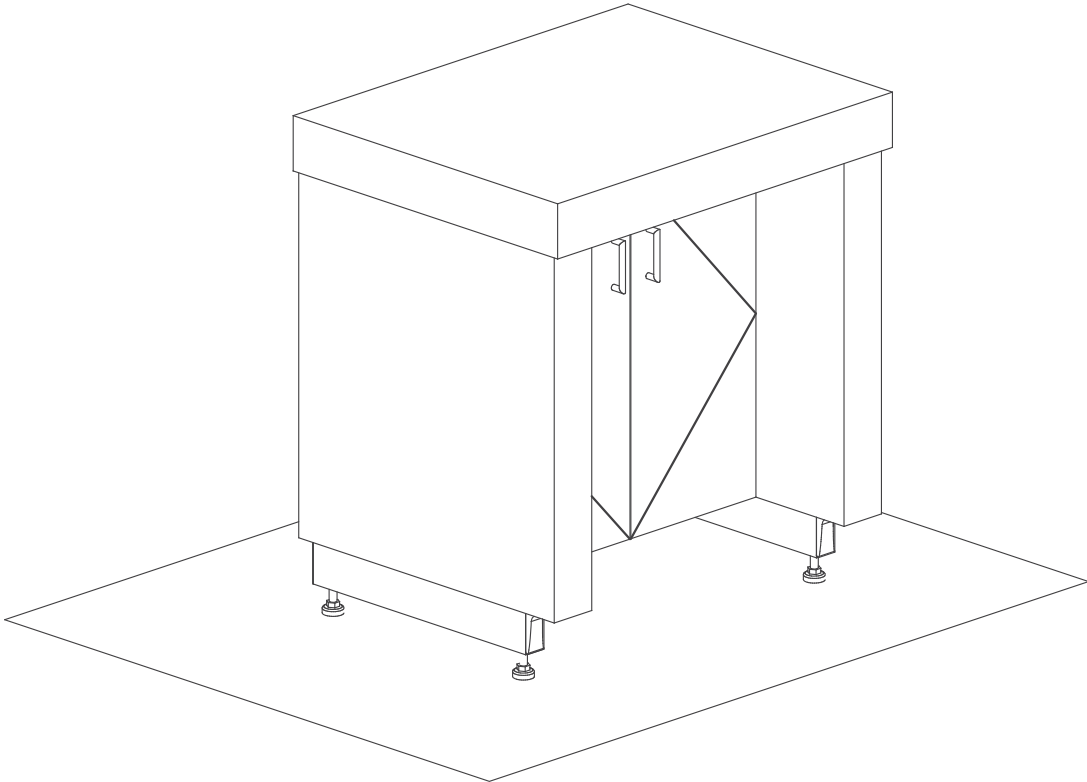

Balance Table Component Description

1. Balance Cabinet - Galvanized steel seet with white coated

2. Balance Door - Galvanized steel seet with white coated

3. Balance Fram

4. Adjustable leg set & tube cover

5. Worktop (not include)

6. Shock absorber

7. Stainless handle



8. Upper frame with black powder coating

Dimension (mm)

W	D	H
760	600	800

Type B Steel Storage

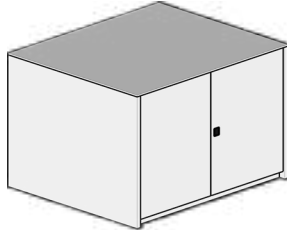
Chemical Storage

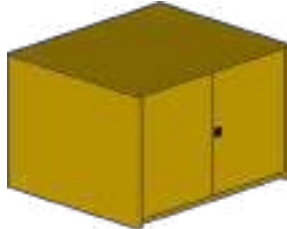
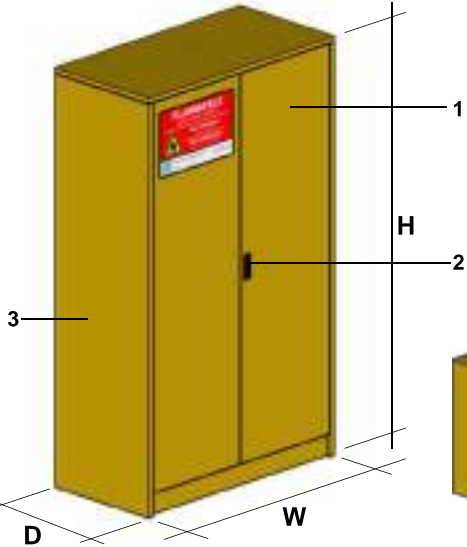

Steel Storage

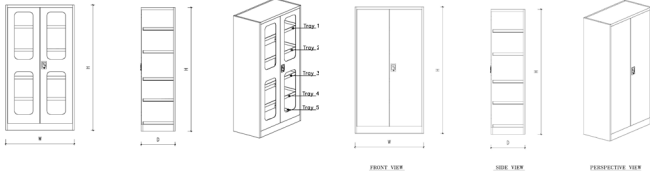
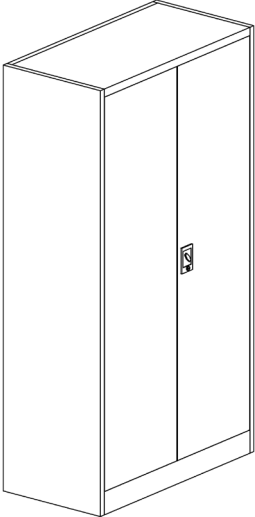
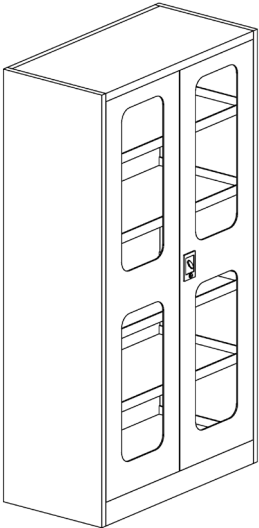

Chemical Storage Details

No	Spesification	Material
1	Steel Door	Powder Coated
2	Handle	Stainless Steel
3	Steel Body	Powder Coated

Dimension (mm)

W	D	H
700/890/1600	590/600/860/1090	460/520/860

Steel Storage Details

No	Spesification	Material
1	Steel Door	5mm glass window
2	Handle	Stainless Steel
3	Shelves	Galvanized Steel Shelves

Dimension (mm)

W	D	H
900/1000/1200	500/600	1850/2000

FUME HOOD

02

On Picture
RL Fume Hood

Fume Hood RL - 150

Full Size
1510 x 900 x 2200

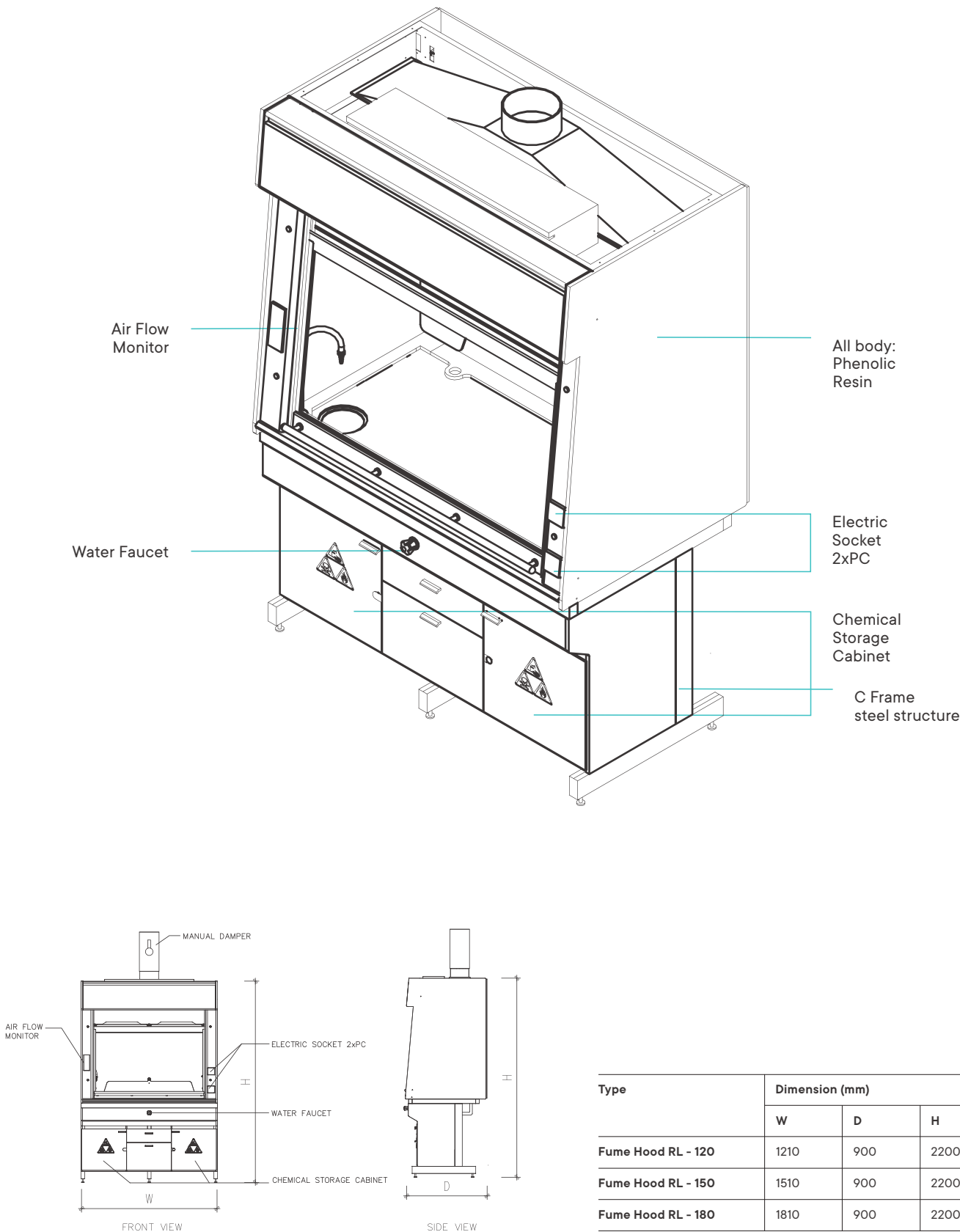

Ductless Fume Hood



Ductless Fume Hood

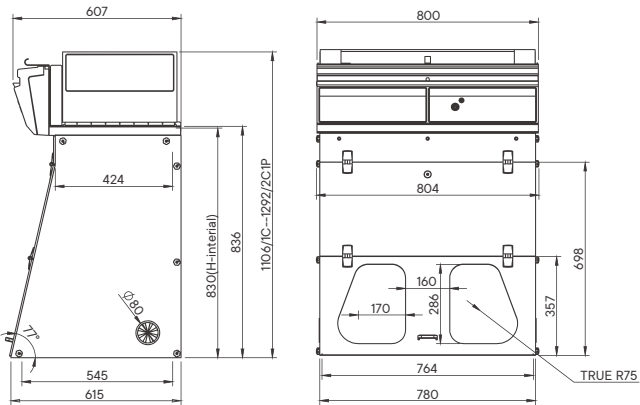

all numbers in mm

Safety Standards	AFNOR NF X 15-211:2009: France - BS 7989: England DIN 12 927:Germany - EN 1822:1998 (HEPA H14 & ULPA U17 Filters) - CE Marking
Air Flow	220 m3/h - 135 CFM
Air Face Velocity	0.4 to 0.6 m/s - 79 fpm to 118 fpm
Voltage/Frequency	220 V / 50-60 Hz
Power consumption	65 W
Sash openings	Oblong
Structure	Corrosion resistant electro-galvanized steel coated with anti-acid polymer
Side and front panels	Chemical resistant acrylic
Filtration module	Polypropylene

EQUIPMENT

Communication interface*	Simple communication by audible and light pulses: unit running time, air face velocity, automatic filter saturation detection, ventilation settings, fan failure alarm.
Filtration technology	1 column that can be configured to handle liquids, powders, or both
Carbon filtration for gases and vapours	Following filtration column configuration (see table above)
Particulate filtration for powders	Following filtration column configuration (see table above)
eGuard*	APP for remote control to monitor the hood, change the settings, and deliver safety alerts immediately to your devices (mobile, tablet and PC)
Internal lighting*	LED lighting > 650 Lux
Anemometer*	Air face velocity alarm
Anemometer**	Air face velocity indicator
Chemical Listing	List of approved chemicals

ACCESSORIES

Work Surfaces	Trespa® Top Labplus, Glass or 304L Stainless Steel
Molecode*	Detection sensor for : Type S, for solvents / Type A, for acids / Type F, for formaldehyde
Benches	Mobile (Mobicap) or fixed (Benchcap)
Bench equipment	Technical gases outlets, water outlets, front control valves, sink, power sockets (Only compatible with Trespa® Top Labplus worktop and fixed bench)
Particulate Pre-filter	Protects the main filter(s) from dust
Transparent Back Panel	Clear acrylic panel for easy viewing

*: Not available on Captain Midcap / **: Not available on Captain Smart

Double Side Fume Hood

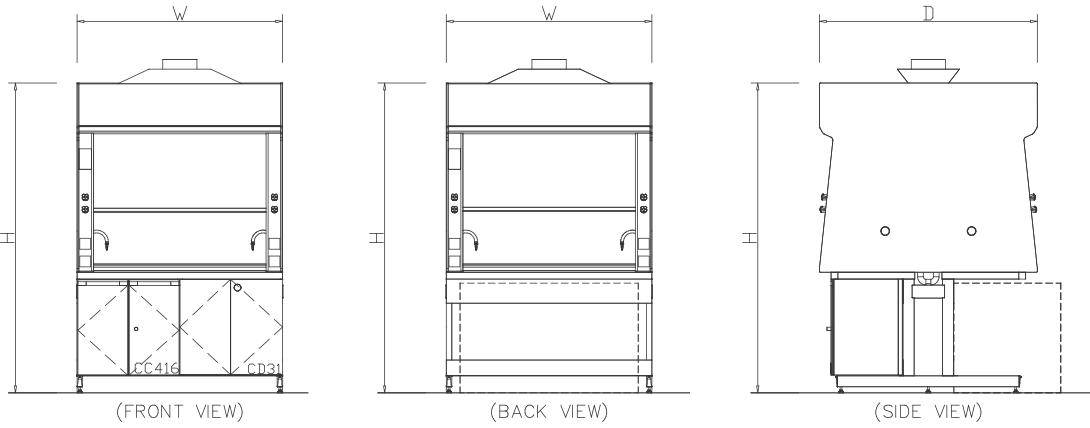
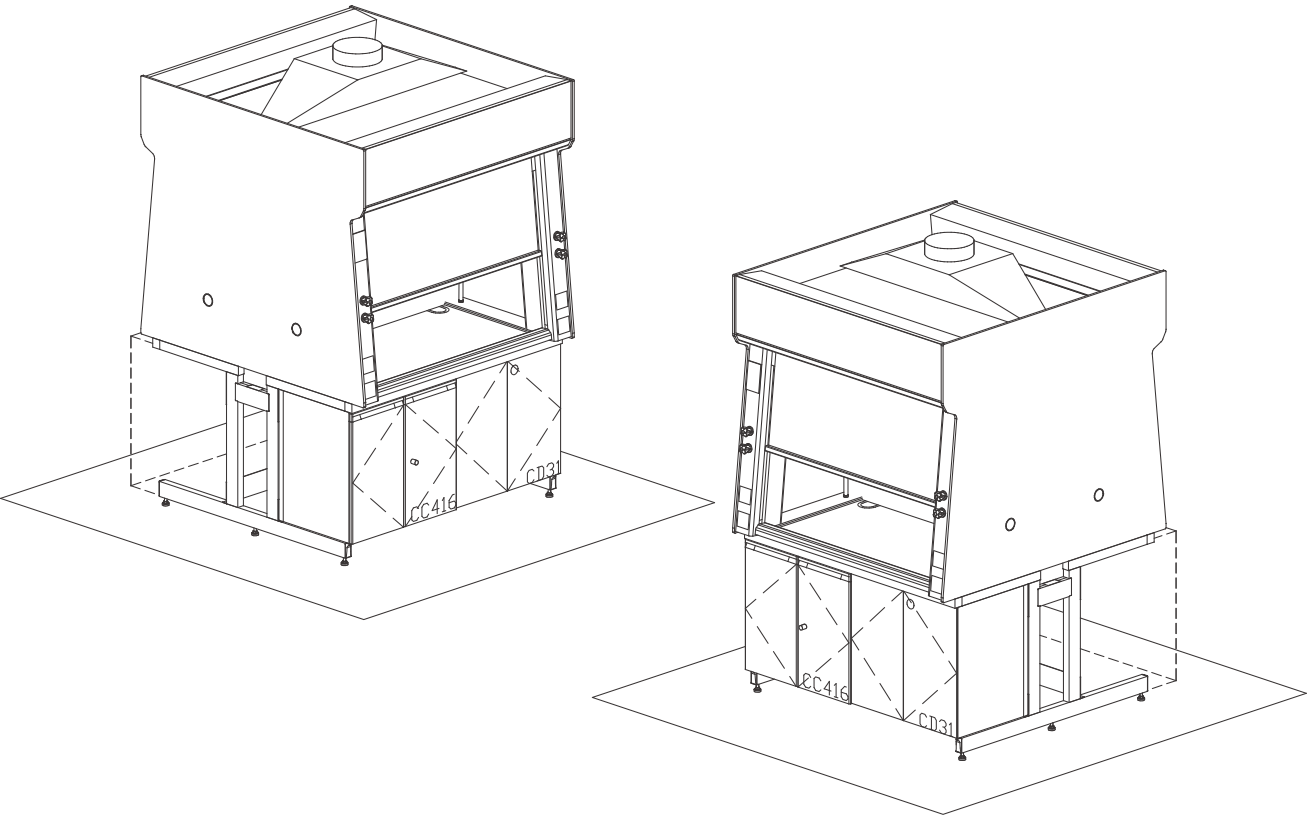

Dimension (mm)		
W	D	H
1200	1590	2260
1500	1590	2260

ACCESSORIES

03



On Picture
Emergency Shower

Pegboard

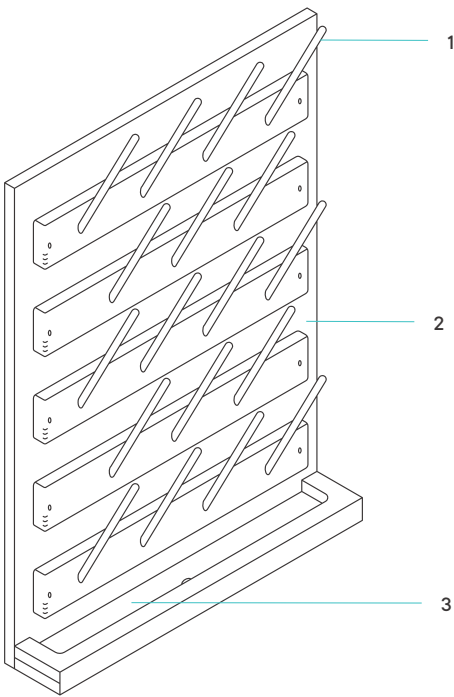

Hanging
Pegboard

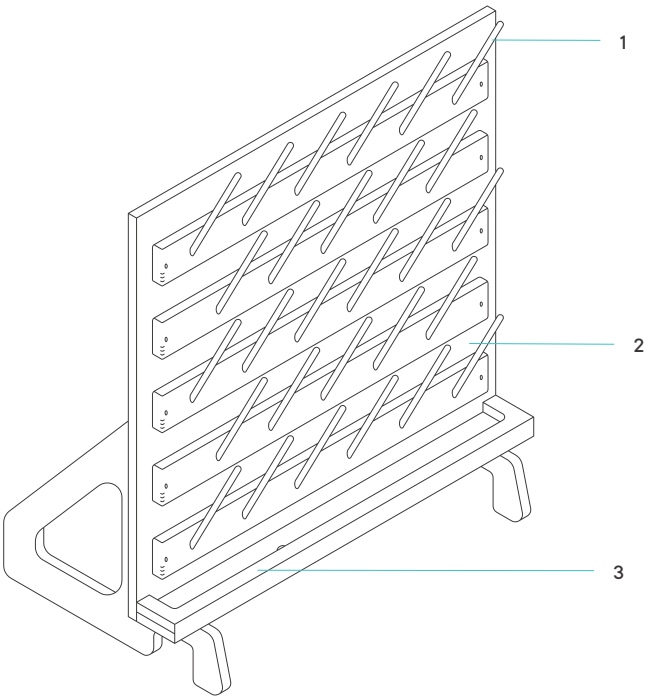

Standing
Pegboard



Hanging Pegboard

No	Spesification	Material		
1	PP Peg	Polypropylene		
2	Phenolic Board	Phenolic Resin		
3	Waste Tray	Phenolic Resin		
Type	Dimension (mm)		H	
	W	D	550	
Hanging Pegboard	400	73	630	
Standing Pegboard	575	335		

Local Extractor

Local Extractor (Ceiling Mount)

Emergency Shower

Eye Shower for Table

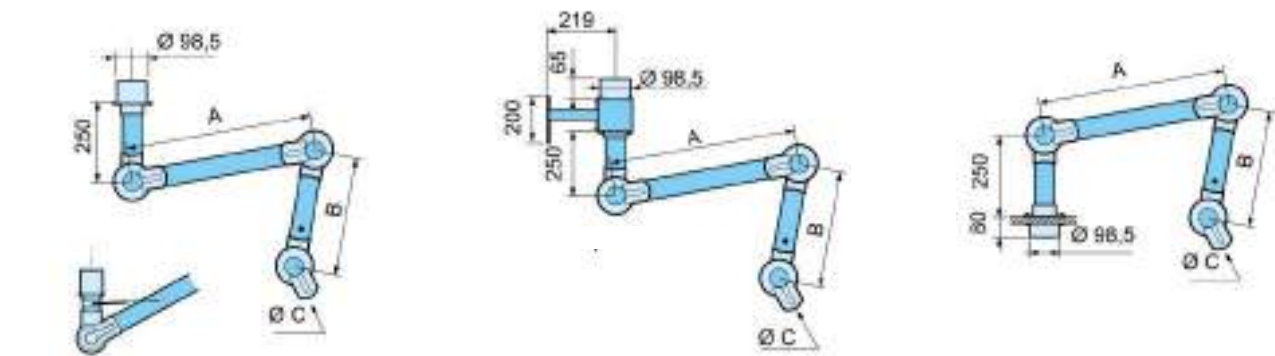

Model With Gas MTS

Ceiling Mount		Size (mm)			Weight
Designation		A	B	C	Kg
MT 1000-75	PP	400	300	75	2.25
MT 1300-75	PP	550	450	75	2.60
MT 1500-75	PP	750	450	75	2.75
MT 2000-75	-	1000	650	75	3.25
MTS 1500-75	PP	750	450	75	3.25
MTS 2000-75	PP	1000	650	75	3.25

Extractors with designation MV always include a wall bracket

Ceiling Mount		Size (mm)			Weight
Designation		A	B	C	Kg
MT 1000-75	PP	400	300	75	4.40
MT 1300-75	PP	550	450	75	4.75
MT 1500-75	PP	750	450	75	4.90
MT 2000-75	-	1000	650	75	5.40
MTS 1500-75	PP	750	450	75	5.25
MTS 2000-75	PP	1000	650	75	5.90

Ceiling Mount		Size (mm)			Weight
Designation		A	B	C	Kg
MT 1000-75	PP	400	300	75	2.25
MT 1300-75	PP	550	450	75	2.60
MT 1500-75	PP	750	450	75	2.75

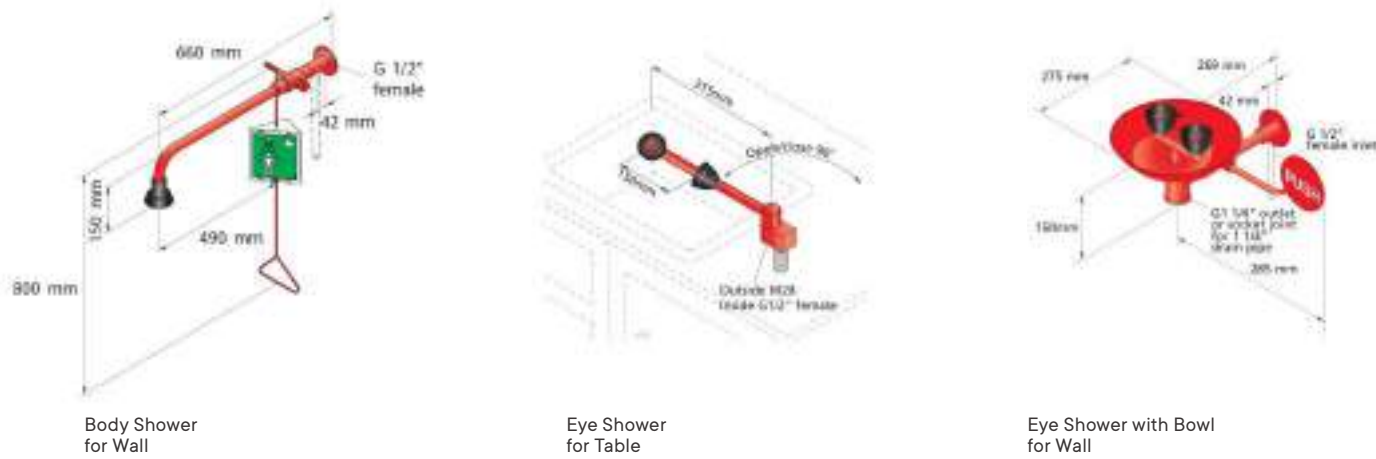

Description	Type
Body Shower for Wall	17.082.009
Eye Shower (for table)	17.231.009 (right of sink)
Eye Shower (for table)	17.230.009 (left of sink)
Eye Shower with bowl (for wall)	17.928.009

Water Fitting, Sink, & Gas Fitting



Fitting Cold water 3 Outlet

Water Fitting

Fitting Cold Water 1 Outlet

6034.084.1001 - 14



Fitting Cold Water 2 Outlet

6033.413.1001 - 14

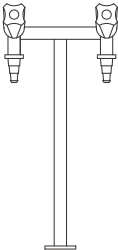

Fitting Cold Water 3 Outlet

6033.385.1001 - 14

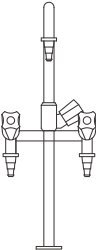

Fitting Hot/Cold Water

6036.001.1039 - 52E

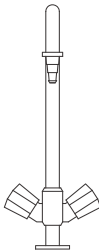

Fitting Demin Water

6033.093.1003



Gas Fitting

Single Gas Fitting

2520.317.1012 - 14



Sink

Modul	Type	Dimension (mm)
PP Sink	PPP - 001 - 103	560 x 428 x 260 mm
PP Big Sink	PPP - 001 - 103A PPP - 001 - 103B	805 x 470 x 315 mm 895 x 465 x 320 mm
Oval Sink	PPP - 025 - 001 PPP - 025 - 002	175 x 102 x 225 mm 264 x 111 x 225 mm
Cup Sink	PPP - 026 - 001 PPP - 026 - 002	168 mm Diameter 102 mm Diameter

PP Sink

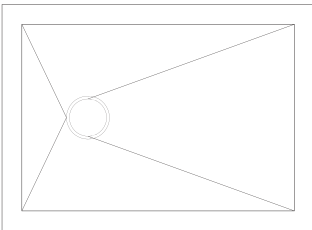

Oval Sink



Cup Sink



Counter Top



Colour	Size	Size
White (T03.0.0)	13 mm	1530 x 3050 mm
Pastel Grey (T03.1.0)		
Silver Grey (T03.4.0)	16 mm	1530 x 3050 mm
Slate Grey (T70.0.0)		
Stale Grey (T90.0.0)		

Colour	Size	Size
Schinee (M 60100)	13 mm	1530 x 3670 mm
Asche (M 60200)		
Nacht (M 60300)	16 mm	1530 x 3670 mm

Colour	Size	Size
White	6 mm	4100 x 1854 mm
White	12 mm	4100 x 1854 mm
White	13 mm	4100 x 1854 mm
White	16 mm	4100 x 1854 mm



Counter Top

SPECIAL
ITEMS

04

On Picture
Sensory Bench

Sensory Bench

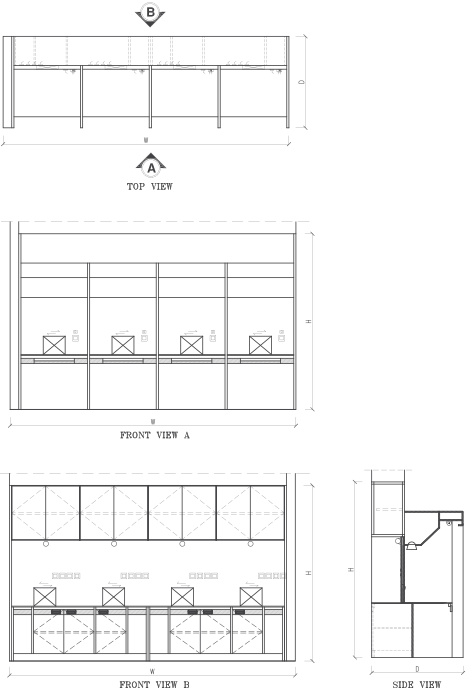
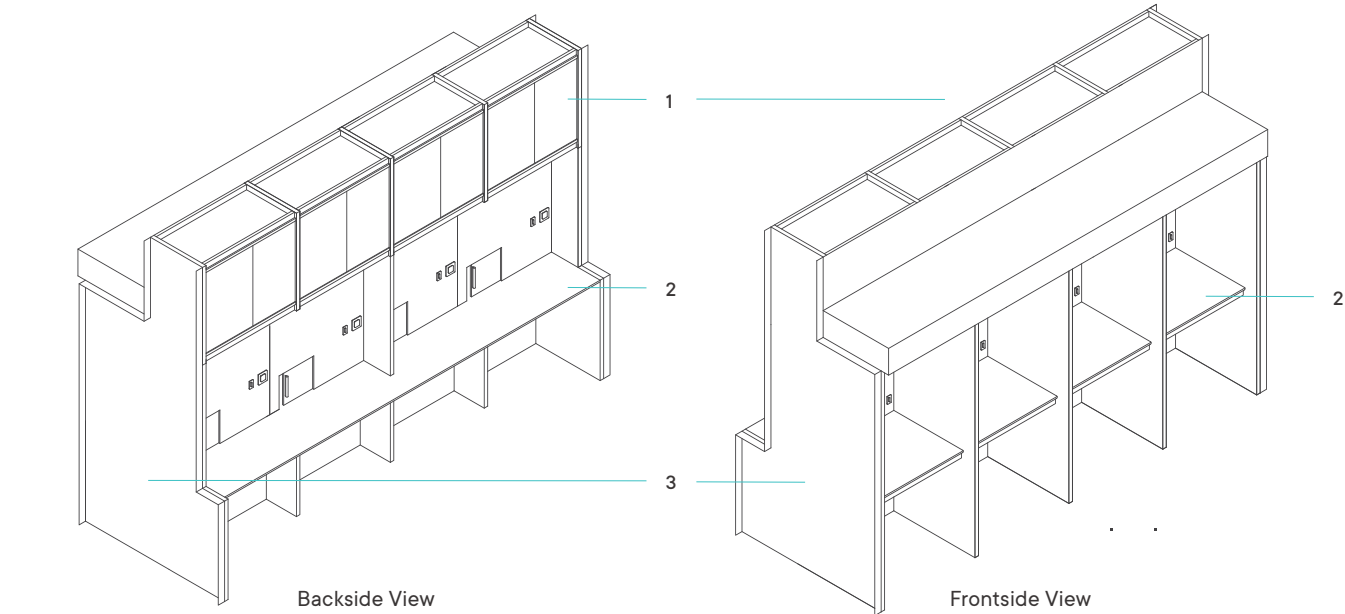

No	Spesification	Material
1	Hanging Rack	Plywood with HPL Melamine
2	Top Table	Phenolic Resin
3	Structure	Wooden Structure with epoxy coated

Dimension (mm)		
W	D	H
Custom	Custom	Custom



SS Hood

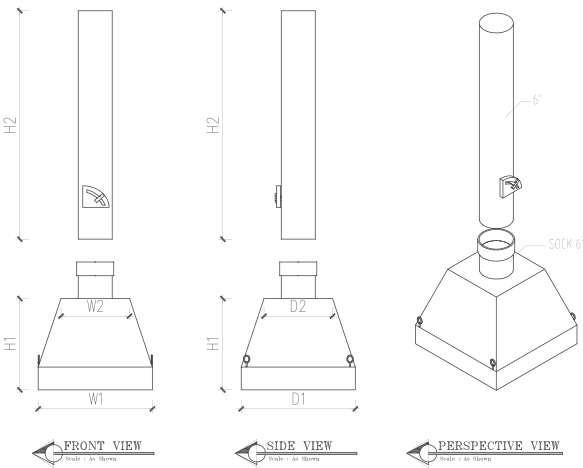

Dimension (mm)		
W	D	H
Custom	Custom	Custom



Custom Stainless Steel Hood

Passbox

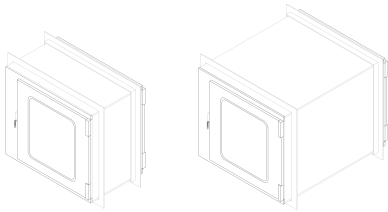

Passbox

W 685
D 400
H 590

Big Passbox

W 685
D 800
H 590



Big Passbox

Low Bench with Shoe Rack

Low Bench With Shoe Rack
Stainless Steel

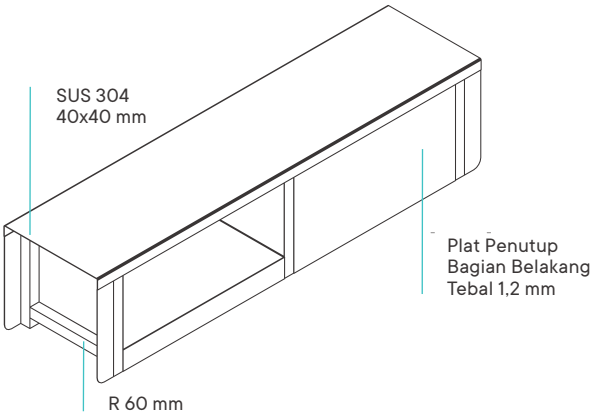

Dimension (mm)		
W	D	H
Custom	Custom	Custom



Low Bench With Shoe Rack
Stainless Steel

Low Bench With Shoe Rack
Phenolic

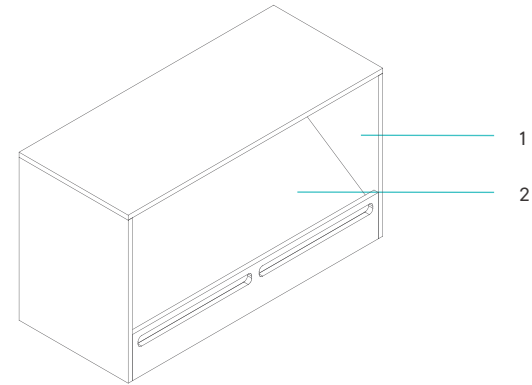

Dimension (mm)		
W	D	H
Custom	Custom	Custom



Low Bench With Shoe Rack
Phenolic

Incubator Rack

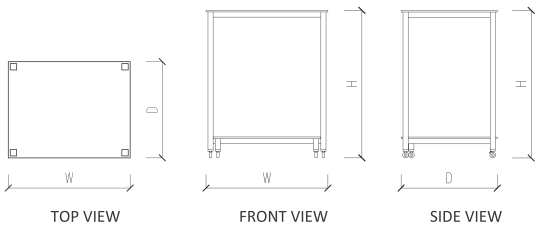
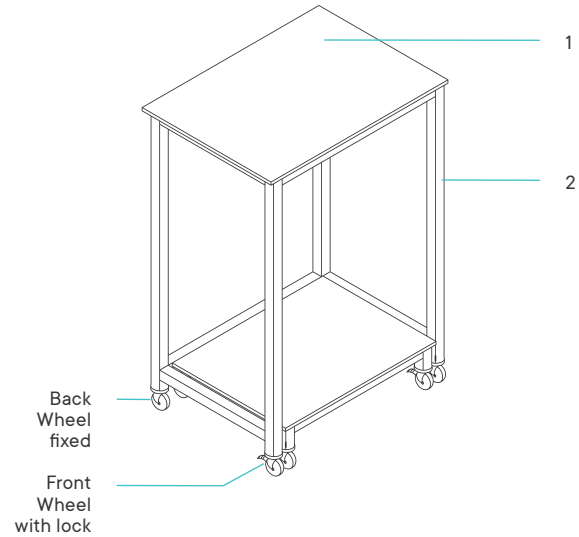

No	Spesification	Material
1	Top Pannel	Phenolic Resin
2	Strucure	Stainless Steel

Dimension (mm)		
W	D	H
Custom	Custom	Custom



Incubator Rack

GAS AND PIPE

05



On Picture
Pressure Gauge



Valve Outlet



Valve Outlet



Gasline with bracket

PARTNERS

QUALITY IS INTERNATIONALLY RENOWNED WITH A GLOBAL SUPPLY CHAIN. WE UTILIZE ONLY HIGHLY RELIABLE PARTNERS AND SUPPLIERS THAT COMPLY WITH DOMESTIC AND INTERNATIONALLY RECOGNIZED STANDARD TO ENSURE MAXIMUM QUALITY AND CONGRUENCE WITH OUR PRODUCTS.



LABTECH EQUIPMENT CORP (TAIWAN)

Founded in 1979 in Taipei, Labtech is Taiwan's leading Laboratory furniture company that use high quality steel and has flexible system that is highly adaptable in many laboratory. The company is also executive member of SEFA. PT.RGA has worked alongside with Labtech for a number of projects in Indonesia.



ERLAB® (FRANCE)

Created over 40 years ago in 1968, ErLab® was the first ever to invent Captair® the first ductless filtering fume enclosure for the filtration of toxic chemicals. Since its creation, the company, a pioneer in its fields has always had the know-how to offer the most efficient system in terms of filtration quality and filter life.



ADVANCELAB (SINGAPORE)

AdvanceLab produces quality Flammable and Acid Storage Cabinets that are well known in Asia Pasific.



Wall Bench (LABTECH)



Captair 822 Smart (ERLAB)



Floor Mounted Steel Furniture (ADVANCE LAB)

**Head Office**

Jl. Pondok pinang raya No.3,
Jakarta Selatan, 12310 Indonesia

T +62 21 2270 5975/76/77

F +62 21 2270 5978

Factory

Techno Park Sector XI, Blok E3/
26-27 BSD, Tangerang, Indonesia

T +62 21 75880029

F +62 21 75880030